

PURDUE
UNIVERSITY

LAND SURVEYING AND GEOMATICS
ENGINEERING
RESUME BOOK
2005 - 2006

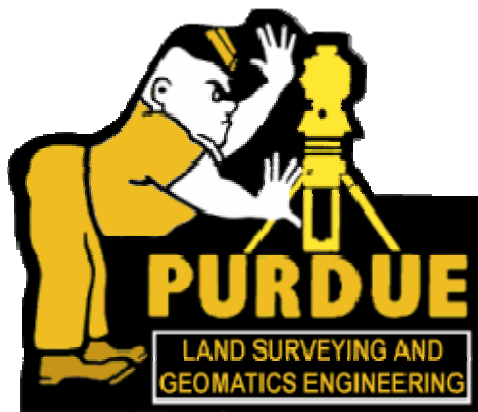

School of Civil Engineering
Land Surveying and Geomatics Engineering Area
Student Chapters of the American Congress on Surveying and Mapping
&
Indiana Society of Professional Land Surveyors

TABLE OF CONTENTS

MAY 2006 GRADUATES

Aaron James Carl
Christopher David Carmien
Kristopher Eichhorn
Gene K. Gosewehr
Matthew R. Healy
John E. Kinkle
Kelly Lynn Miller
Nickolas M. Schmitt
Anthony Squellati
Charles W. Thompson III

AUGUST 2006 GRADUATES

Christopher DeYoung
Kevin Redelman

DECEMBER 2006 GRADUATES

Michael George Judt

MAY 2007 GRADUATES

Jeffrey Fox
Nathan D. Harris
Thomas Ryan Henderson
Andrew J. Kincaid
Andrew Thomas Miller
Clint W. Roos
Ashley L. Rose
Matthew Thomas
Robert Frederick Will
Scott E. Wilkinson

MAY
2006
GRADUATES

Home:
633 Etna Avenue
Huntington, IN. 46750
Phone (260) 358-0343
e-mail: ajcarl_007@hotmail.com

Campus:
142 Halsey Street, Apt. 6
West Lafayette, IN 47906
Phone (765) 496-4741
e-mail: acarl@purdue.edu

Aaron James Carl

OBJECTIVE:

To obtain a career in Land Surveying Engineering.

WORK EXPERIENCE:

- Summer 2005: Karst Surveying Fort Wayne, IN
- Field Technician
- May 1999-August 2003 and Summer 2004: Sauer Land Surveying, Inc. Fort Wayne, IN
- Auto CAD Department Superintendent
 - Boundary Surveying
 - Computer Networking
 - Site Planning
 - Construction Stakeout
 - Website Design
- August 2002-December 2002: Indiana Purdue Fort Wayne Fort Wayne, IN
- Math Tutor
- September 1998-May 1999: Superior Auto Huntington, IN
- Mechanic
- June 1996-June 1998: Agri-motive Products, Inc. Warren, IN
- CAD Supervisor
 - Wire Harness Technician
 - Maintenance
 - Department Supervisor
 - Grounds Keeping

EDUCATION:

- 2003-Present: Purdue University West Lafayette, IN
- 1998-2003: Indiana University-Purdue University Fort Wayne, IN
- 1994-1998: Huntington North High School Huntington, IN
- 8 Semesters of Auto CAD
 - FFA
 - Wrestling
 - Soil Judging

ACTIVITIES:

- Northeast Chapter ISPLS Associate Member
- Tecumseh Chapter ISPLS Student Member
- State ISPLS Student Member
- Huntington County Freestyle Wrestling Club
- ATV Racing/Riding
- Hunting
- 4-H

REFERENCES:

Available upon request

CHRISTOPHER DAVID CARMEN

OBJECTIVE

To secure a full time position in land surveying engineering to serve as a benchmark in my professional surveying and engineering career.

EXPERIENCE

Summer of 2003 - 2005 Reith Riley Construction Gary, IN

Surveying, Estimating & Construction Management (Summer Intern)

- Performed construction layout for Toll Road and other various jobs. Utilizing Topcon hiper plus GPS and GPT-8000 total station.
- Created quotes and estimates using HCSS Heavy Bid.
- Generated detailed estimates of I-80/94 using Microstation.
- Produced and presented a presentation for a \$5 million change order to Indiana Toll Road officials.
- Helped supervise construction crews on U.S. 41 through Highland.

2000–2002 Sauer Land Surveying Ft. Wayne, IN

AutoCAD Drafting Technician

- Drafted plans for subdivision design, plot plans, lot surveys, and other engineering work.
- Performed fieldwork on a regular basis for mortgage and topographic surveys.

EDUCATION

2001–Present Purdue University West Lafayette , IN

- Pursuing a Bachelor degree in Civil Engineering and a Bachelor degree in Land Surveying Geomatics Engineering.
- 3.82 grade point average
- Intended graduation in May of 2006.

ACHIEVEMENTS & AWARDS

- Social chair for Phi Sigma Pi honor fraternity
- Eagle Scout Award
- Semester Honors and Deans List every semester
- An active member in ASCE, Chi Epsilon, ACSM, Golden Key Honor Society, and ISPLS

REFERENCES

Will be presented upon request.

E-MAIL: CCARMEN@PURDUE.EDU

1953 CAL DRIVE • WEST LAFAYETTE, IN 47906 • PHONE (260) 312-1317

332 S. Chauncey Ave Apt 1
West Lafayette, IN 47906

6251 N Raider Rd
Middletown, IN 47356

keichhor@purdue.edu
765-606-4387

Kristopher Eichhorn

Objective Find permanent employment in a Civil Engineering and/or Land Surveying firm.

Experience 2005 Indiana Dept. of Transportation Greenfield, IN
Engineering Intern

Assisted Project Engineer in field tests and data collection.

2004 Indiana Dept. of Transportation Indianapolis, IN
Engineering Intern

Worked in Hydraulics Department performing preliminary hydraulic analysis.

2003 Indiana Dept. of Transportation Greenfield, IN
Engineering Intern

Assisted Project Engineer in field tests and data collection.

Skills and Abilities

- Microsoft office, AutoCAD, EaglePoint, ArcGIS, HY8, SimTraffic, MOVE3, Synchro, HTML

Education 2001-2005 Purdue University West Lafayette, IN

- Civil Engineering / Land Surveying and Geomatics Engineering Dual Major
- GPA 3.61/4.00

Activities

- Lambda Sigma Treasurer
- ISPLS Member
- ASCE Member
- Chi Epsilon Member
- Golden Key Member
- Tau Beta Pi Member

830 Millerwood Dr.
Lebanon, IN 46052

Phone (317) 797-7071
Fax none
E-mail egoseweh@purdue.edu

Gene K. Gosewehr

Objective

Seeking an entry-level position at a Land Surveying Engineering firm or the Land Survey department of a civil engineering firm with opportunities for advancement.

Education

August 2001 - Present Purdue University West Lafayette, IN

BS degree in Land Surveying and Geomatics Engineering, Mgmt. Minor

- Relevant courses include: Fundamentals of Surveying, Photogrammetry, Route Survey Design, Engineering Economics, Property Surveys and Descriptions, Oral and Technical Communication, History and Ethics of Surveying and GIS Tools.
- Experienced Microsoft Office Tools. Experienced with MathCAD, MATLAB, Basic C Programming, AutoCAD, MOVE3, Eagle Point and various COGO software.

Professional experience

Summer 2002, 03', 04', 05' B F & S Engineering Indianapolis, IN

Summer Employment

- Assisted Survey crews in the field for various types of projects involving total station and GPS surveys.
- Processed the Surveys using AutoCAD and making corrections, prepared final survey maps and data for design purposes.

Professional memberships

Current member and student representative of the Purdue student chapter of the American Congress on Surveying and Mapping (ACSM), member of The Indiana Society of Professional Land Surveyors (ISPLS) Tecumseh Chapter.

Extracurricular activities

Member of Best Buddies at Purdue University, Sowing the Seed, involved in intramural flag football, volleyball, basketball and softball.

References

Available upon request.

Matthew R. Healy

School: 101 Andrew Pl. Apt #208
W. Lafayette, IN 47906
(812)827-4719
healym@purdue.edu

Home: 4055 W. Hillcrest Dr.
Jasper, IN 47546
(812)634-2133

Objective A position in the land surveying field that uses both my surveying and engineering skills.

Education Purdue University, W. Lafayette, IN
Major: Land Surveying and Civil Engineering
Expected Graduation Date: May 2006
Grade Point Average: 3.47 (on a 4.0 scale)

Employment
5/2001-present RQAW Corporation, Indianapolis, IN
Conducted deed research, adjusted field work, and prepared drawings for route surveys. Prepared point files and drawings for field crew to use in construction staking. Prepared survey drawings for engineers and architects using AutoCAD Land Development Desktop. Assisted a project engineer in road design and plan preparation. Worked on the survey field crew. Jobs included topography, route surveys, right-of-way staking, and boundary/ALTA surveys using both GPS and a total station.

2/98-8/2000 Uebelhor & Sons Motors, Jasper, IN
Washed cars to prepare them for delivery to costumers. Detailed cars that had been traded in so they could be put on the lot. Cleaned the floors in the service shop. Acted as manager from 5:00 pm to 7:00 pm.

Honors, Awards, and Organizations

Chi Epsilon (Civil Engineering Honor Society)
American Congress of Surveying and Mapping Purdue Student Chapter
Indiana Society of Professional Land Surveyors
Lambda Sigma (Land Surveying Honor Society)-President

Additional Information

Member of the football and track teams all four years of high school
Tuition self-financed since sophomore year

References Available upon request.

John E. Kinkle

Current Address:

931 Sixth Street
West Lafayette, IN 47906
(765) 414-0072

Permanent Address:

2304 Taylor Avenue
Princeton, IN 47670
(812) 386-7791

jkinkle@purdue.edu

OBJECTIVE

A position with a construction management or land surveying firm where my experience of field operations can be utilized effectively.

EDUCATION

Purdue University

Bachelor of Science in Land Survey and Geomatics Engineering;
and Construction Engineering and Management
School of Civil Engineering, West Lafayette, IN
May 2006

WORK EXPERIENCE

Martin K. Eby Construction Co., Inc.

Field Engineer Intern, Orlando, FL
May 2004-Aug 2004

- In charge of layout and construction of retaining wall
- Assisted full time employees with layout
- Toll plaza expansion project

Field Engineer Intern, Lakeland, FL
May 2003-Aug 2003

- Assisted full time employees with layout
- Provided horizontal and vertical control for sound wall
- Sixteen mile interstate widening; seven bridges

Field Engineer Intern, Ocala, FL
May 2002-Aug 2002

- Assisted full time employees with layout
- Layout of roadwork, storm drains, and retention ponds
- Eight mile road widening

Krieger Brothers Excavating Co.

Field Engineer, West Lafayette, IN
Aug 2005

- Layout of storm water retention areas
- Tracking fill operation for new Menards building

Discount Den

Cashier
Dec 2004- Present

ACTIVITIES AND HONORS

Eagle Scout

ACSM/ISPLS

Intramural Sports (Tennis, Soccer, Bowling)

Lambda Chi Alpha, Academic Chair

Lambda Chi Alpha, Social Chair

Kelly Lynn Miller

Present Address:

351 W. Oak St.
West Lafayette, IN 47906
(765) 414-0896

Permanent Address:

871 Meadowdale Ct.
Valparaiso, IN 46383
(219) 465-2026

Email: millerkl@purdue.edu

Objective: To obtain a full time position in the field of transportation or land surveying engineering.

Education: Purdue University, West Lafayette, IN
Major: Civil and Land Surveying Geomatics Engineering
BSCE, BSLSGE
Expected Graduation Date: May 2006
CE/LSGE GPA: 3.25 Grad GPA: 3.03

Employment Experience: *Summer 2005*
Nick Miller, Inc., Palm Beach Gardens, FL
Set monuments, leveled, and prepared submittals of water well elevations for the South Florida Water Management District. Recreated sections in GIS for the Highlands County, Florida surveyor's office for use in retrieving parcel information.

Summer 2004
Joint Transportation Research Program (JTRP), Purdue University
Performed research on stone matrix asphalt under the direction of Prof. John E. Haddock.

June 2003 - present
John E. Fisher & Associates, P.C., Lafayette, IN
Determined site grades and performed hydrology calculations for various site conditions using Land Development Desktop. Completed ALTA surveys and calculations. Researched deed records at the county level.

November 2002 - present
Riverside Skating Center, West Lafayette, IN
Interpersonal relations and supervision of patrons while on and off the ice-skating arena. Operational and monetary responsibilities of the cash register. Operation of the Zamboni and skate sharpener.

Organizations/Honors

- John M. Hayes Chapter of ASCE, President-2004, Treasurer-2003
- Letter of Significant Improvement, Letter of Honorable Mention, ASCE-2004
- Workshop for Student Chapter Leaders, ASCE-2003 & 2004
- Purdue Engineering President's Council-2004
- American Congress of Surveying and Mapping (ACSM) and Indiana Society of Professional Land Surveyors (ISPLS), President-2005/6,
- Women in Engineering Mentor and Mentee Program, Mentor-2004/5
- Civil Engineering Ambassador-2005/6
- College of Engineering Ambassador-2005/6
- John G. McEntyre Endowment, Margaret Cunningham Scholarship Recipient-2004
- Participated in NSPS/NCEES study to educate high school students about the land surveying profession-2004

References: Available upon request.

NICKOLAS M. SCHMITT

317 Whippoorwill Heights
New Albany, IN 47150
Phone: (502) 641-3269
Email: nschmitt@purdue.edu

Objective	To earn a position in the field of civil engineering and land surveying and geomatics engineering.
------------------	----------------------------------------------------------------------------------------------------

Education	Purdue University, West Lafayette, IN Dual Degree: Civil Engineering and Land Surveying and Geomatics Engineering Expected Graduation Date: May 2006
------------------	---------------------------------------------------------------------------------------------------------------------------------------------------------------

Employment Experience	6/2005-8/2005, 5/2004-8/2004, & 5/2003-8/2003 Summer Engineering and Construction Internship Gohmann Asphalt and Construction Incorporated, Clarksville, IN Worked in the materials laboratory testing aggregates and asphalt to make sure they passed INDOT and KYDOT engineering specifications. Also, contributed in creating Excel spreadsheets files to calculate and record laboratory data. Earned a promotion the second year of employment that allowed me to run an asphalt materials laboratory, which consisted of testing and recording all the data for several highway projects, on my own. Obtained qualification to run a profilograph for INDOT projects in the third year of employment. 5/2002-8/2002 Summer Engineering and Surveying Internship Bob Isgrigg and Assoc. Civil Engineering and Land Surveying, Jeffersonville, IN Worked with a professional engineer in designing subdivisions, drainage systems, and septic systems using AutoCAD. Worked on a survey field crew running property lines, performing boundary survey's, checking elevations, and stacking off subdivisions, drainage sewers, and houses.
------------------------------	---------------------------------------------------------------------------------------------------------------------------------------------------------------------------------------------------------------------------------------------------------------------------------------------------------------------------------------------------------------------------------------------------------------------------------------------------------------------------------------------------------------------------------------------------------------------------------------------------------------------------------------------------------------------------------------------------------------------------------------------------------------------------------------------------------------------------------------------------------------------------------------------------------------------------------------------------------------------------------------------------------------------------------------------------------------------------------------------------------------------------------------------------------------------

Honors & Awards	Semester Honors 7 Times Currently on Dean's List Grade-Point-Average: 3.62 (on a scale of 4.0) The 2004 Purdue Rollyn Blankenkemper Memorial Scholarship (Land Surveying) The Albert James Horth Memorial Scholarship Endowment (Civil Engineering)
----------------------------	-----------------------------------------------------------------------------------------------------------------------------------------------------------------------------------------------------------------------------------------------------------------

Activities	Member of PSUB (Purdue Student Union Board) sophomore year. Member of ASCE (American Society of Civil Engineering) Member of Chi Epsilon (National Civil Engineering Honors Fraternity) Secretary and member of Lambda Sigma (Land Surveying Honors Society) Student Representative and member of ACSM/ISPLS (American Congress on Surveying and Mapping/Indiana Society of Professional Land Surveyors)
-------------------	----------------------------------------------------------------------------------------------------------------------------------------------------------------------------------------------------------------------------------------------------------------------------------------------------------------------------------------------------------------------------------------------------------------------

References	Presented upon request.
-------------------	-------------------------

Anthony Squellati

Objective Geomatics Engineering position that will provide a wide range of field and office experience in preparation for successfully passing the Professional Land Surveyors Exam

Education ***M.S. Geomatics Engineering (August 2005 - Present)***
Purdue University, West Lafayette, Indiana
¼ Time Teaching Assistant, ¼ Time Research Assistant (SAR Research)
Expected Graduation Data: August 2006

B.S. Geomatics Engineering (September 2001 – May 2004)
California State University, Fresno
Graduation Status: *Summa Cum Laude*
GPA at California State University, Fresno: 3.93
Cumulative Undergraduate College GPA: 3.82

Geomatics Engineering Major – Coursework includes:

- GPS
- Photogrammetry
- Digital Mapping
- Least Square Adjustments (Advanced Adjustment Computations)
- GIS (ARC INFO)
- Computer-Aided Drafting (Microstation, AutoCAD)
- Microcomputers in Engineering (C Programming)
- Legal Descriptions
- Boundary Control and Legal Principles
- Geodesy
- Advanced Physics
- Advanced Calculus

August 2000 – June 2001
Shasta Community College, Redding, CA
GPA: 3.50

Geomatics Engineering Major, University Express Program

- Engineering Surveying and Field Laboratory
- Computer-Aided Drafting (AutoCAD)
- Calculus and Physics
- Starting Football Player

Shasta High School, Redding, CA

- Graduate – Class of 2000
- Classes Included: Pre-Calculus, Spanish (3 Years), Computers

Work Experience

June 2004 - August 2005
Andregg Geomatics, Auburn, CA
Job Title: *Project Surveyor*

- 3-D Laser Scanning – Field (Leica HDS 3000) and Office Work (Cyclone 5.2)
 - Worked on 22 different 3-D Laser Scanning Jobs
 - Forensics, Bridge, Highway, Dam, Wastewater, Architecture, Construction, Monitoring Surveys, Surface Modeling, Topographic Surveys, Volume Surveys, Tunnel, and Piping Systems
 - Point Cloud Registration, Database Management, Exporting 3-D scan data into 2-D CAD Deliverables, 3-D Movie Fly-Thru Deliverables
- GPS Field Collection (Trimble 4000 and 5800) and Office Processing (TGO)
 - Processing Fast Static Networks to Generate Project Control
 - RTK Office Site-Calibration, RTK Field Site-Calibration, Download, Upload
- Right of Way Mapping, Control Surveys, Writing Legal Descriptions, Researching Record Documents and Maps, Compiling Record of Surveys, Topographic Surveys with Record Boundaries, Surface and Terrain Modeling, AutoCAD LDD 2004

May 2003 – August 2003

Pacific Gas and Electric, San Francisco, CA

Job Title: *Summer Intern-Land Technician*

- Traveling Crew Member, Bakersfield to Oregon Boarder
- Surveying (GPS, Traverse, Topo, Alignments, Leveling), Data Processing, Microstation-V8

June – August 2002

CH2M Hill Geospatial Engineering, Redding, CA

Job Title: *Summer Intern*

- Surveying (GPS, Traverse, Topo, Leveling, Setting Aerial Targets), GIS (ArcView), Microstation, AutoCAD

Certification

- Land Surveyor-In-Training Certified – No LST 6551 (January 2003)
- 3-D Laser Scanning, Leica HDS Training Completed – San Ramon, California (June 04)

Professional Memberships

- Indiana Society of Professional Land Surveyors (ISPLS)
- California Land Surveyors Association (CLSA)
- American Congress on Surveying and Mapping (ACSM)
- Northern Counties Section of American Congress on Surveying and Mapping (NCS-ACSM), California

Awards

Honors and Scholarships

- Member, California Rho Chapter of Tau Beta Pi Engineering Honor Society
- Member, Golden Key International Honor Society
- Member, The Honor Society of Phi Kappa Phi
- Member, CSUF Chapter of Lambda Sigma National Land Surveying Honor Society
- CSUF Dean's Honor Roll (Fall 2001 – Spring 2004), CSUF President's List Fall 2002, Fall 2003
- California Transportation Foundation Scholarship, Spring 2004
- CLSA Channel Islands Chapter Scholarship, Spring 2004
- Western Federation of Professional Surveyors Scholarship 2002, 2003, 2004
- Leon S. Peters Engineering Scholarship 2003, 2004
- Northern Counties Chapter CLSA Scholarship 2002, 2003, 2004
- CLSA Orange County Chapter Scholarship 2002, 2003
- ACSM Schonstedt Scholarship in Surveying Spring 2003
- NSPS Board of Governors Scholarship Spring 2003
- CLSA James E. Adams Memorial Scholarship Spring 2003
- Martin M. Ron Associates, Inc Land Surveyors Scholarship Spring 2003
- Johnson-Frank & Assoc. Land Surveying and Geomatics Engineering Scholarship, Spring 2003
- Los Angeles County Foundation of Civil Engineers & Land Surveyors Scholarship, Fall 2002
- Robert & Norma Craig Engineering Scholarship Fall 2002
- Geomatics Engineering Honor Scholarship at CSU, Fresno 2001-2002
- Shasta High School Athletic Boosters Scholarship Fall 2000

Athletic Awards

- Shasta High School Football Varsity Team Captain 1998, 1999
- Eastern Athletic Football All-League 1998, 1999
- Shasta High School Most Valuable Player: Football 1996, 1997, 1998
- Shasta High School Most Valuable Player: Baseball 1997
- Redding Elks Club Outstanding Athlete Award, May 1999
- Northwest Awards Athlete of the Season, Fall 1998

Professional Activity and Workshops Attended

- Speaker at the 2005 California State University, Fresno Geomatics Engineering Conference
Topic: Evolving Deliverables Through High Definition Surveying
- Easements and Reversions Workshop, Pacific Land Seminars, 2004 Concord, CA
- NCS-ACSM ALTA/ACSM Land Title Surveys Workshop 2003 in Dublin, CA
- NCS-ACSM Terrestrial & Airborne LIDAR Workshop 2003 in Sacramento, CA
- ACSM National Conference 2003, Phoenix, AZ
- CLSA State Conference 2002 in South Lake Tahoe, NV
- CSU, Fresno Geomatics Engineering Conference (2002, 03, 04, 05), Fresno, CA

Interests

All sport, especially Weight Training, Snowboarding, Wakeboarding, Hunting, and Fishing; also Guitar and Computers

I am a team player and a dependable, enthusiastic worker

Charles W. Thompson III

Home

17222 Roosevelt Pl.
Lowell, IN 46356
(219) 696-7107

cwthomps@purdue.edu

School

100 Sylvia St. Apt # 3
W. Lafayette, IN 47906
cell - (219) 789-8450

Objective

Seeking a full time position under a professional Land Surveyor to gain experience in either a Civil Engineering or Land Surveying Engineering firm.

Education

- Currently a fifth year senior attending Purdue University, West Lafayette, IN Pursuing Bachelor of Science degrees in both Civil Engineering and Land Surveying and Geomatics Engineering.
- Experienced in general computer skills along with, MathCAD, Matlab , AutoCAD, Eagle Point, Land Desktop, Microstation, ArcGIS and other Cogo programs. Also experienced in surveying methods, traversing, staking, basic road design, topographical mapping, and computer and hand drafting.
- Expected Graduation Date: May 2006

Activities

- Purdue student chapter of the:
American Congress on Surveying and Mapping (ACSM) 2003-present,
Secretary 04-05, Vice President 05-06
- The Indiana Society of Professional Land Surveyors (ISPLS) 2003-Present
- American Society of Civil Engineers (ASCE) 2004-present
- Intramural basketball, Tae Kwon Do, Habitat for Humanity

Employment

Summer 2005 – Present **Tippecanoe County Surveyor's Office** Lafayette, IN
Part-time work

- Section corner locating and maintenance.
- Resetting destroyed monuments and references.
- Updating, rectifying, and adding aerial images to section corner dossiers using Microstation.

Summer 2004 & Winter 2004 **Woolpert LLP** Indianapolis, IN
Surveying Internship

Office, AutoCAD Technician

- Created several plats of survey for Land Title Surveys, Topographic surveys, and Boundary surveys using Autodesk Land Desktop and AutoCAD.
- Deed research
- Utility locating

Field, Rodman

- Construction staking and Topographic Surveying using Robotic Total Stations and GPS

References Available upon request

AUGUST
2006
GRADUATES

Christopher DeYoung

Campus Address

Room 211, Tarkington Hall
Purdue University
1165 West Stadium Drive
West Lafayette, IN 47907-4235
765-495-1309

Permanent Address

527 E. 168th Pl.
South Holland, IL 60473
708-596-7619
Email: cdeyoung@purdue.edu

Objective: Full time position in Land Surveying and Geomatics Engineering and Civil Engineering beginning in August 2006.

Education: Purdue University, West Lafayette, Indiana
Bachelor of Science Civil Engineering
Bachelor of Science Land Surveying and Geomatics Engineering
Graduation Date: August 2006

Employment Experience:

- 1/04-current Tarkington Hall, West Lafayette, IN
- Resident Assistant
 - Interact with residents and other resident assistants in order to assist the 44 residents living on my floor
 - Utilize communication and time management skills on a daily basis
- 5/05-7/05 Tarkington Hall, West Lafayette, IN
- Operations Assistant
 - Assist housing services during summer conferences
- 5/04-7/04 Manhard Consulting Ltd. Lombard, IL.
- Land Surveying Internship
 - Practiced Construction Surveying in the field
 - Used Geodimeter Robotic stationing to perform building stakeouts, topographic surveys, as-built surveys
 - Performed leveling on a daily basis
- 8/01-12/03 Purdue University Library: Earth and Atmospheric Sciences Library,
West Lafayette, IN
- Library Assistant and Map Room Assistant

Related Skills: Microsoft Word, PowerPoint and Excel, AutoCAD, MathCAD, Matlab, Eagle Point, ArcGIS, IMAGINE, Move3

Extracurricular Activities:

- American Society of Civil Engineers Member
- Purdue Student Chapter of the American Congress on Surveying and Mapping Member August 2003 - Current
- Indiana Society of Professional Land Surveyors Member August 2004 - Current
- Ski and Snowboard club
- Intramural Sports

Kevin Redelman

Objective To obtain a full time position upon graduation at a professional surveying company that will give me the experience and knowledge in land surveying, so that I may pursue my surveying license.

Education 2001–Present Purdue University West Lafayette, IN

- Pursuing a degree in Land Surveying and Geomatics Engineering
- Anticipated graduation: August 2006

Experience 2005 Preferred Surveying Company Cincinnati, OH

- Field Technician
- Rodman, Instrument operator
- GPS, Construction layout
- Mortgage, boundary, and ALTA surveys

2004–2003 Bock & Clark Land Surveying West Chester, OH

- Field Technician
- Instrument operator, Rodman
- Mortgage, boundary, and ALTA surveys

2003-2000 Shelton Fireworks West Harrison, IN

- Supervised, Trained new workers
- Helped customers

Skills Proficient in AutoCAD, Eagle Point, Matlab, MathCAD, Microsoft office, and FrontPage

Experienced using Topcon and Nikon total stations, HP-48s and TDS Ranger data collectors

Interests American Society of Civil Engineers

- Active on the concrete canoe on the hull design and mix design
- Bridge bust

American Congress on Surveying and Mapping (Purdue Chapter)

- Treasurer

DECEMBER
2006
GRADUATES

Michael George Judt

222 West Wood St. Apt. 13
West Lafayette, IN 47906

(765) 426-1470
mjudt@purdue.edu

OBJECTIVE To be exposed to more aspects of surveying and to gain knowledge into those aspects to improve as a future professional land surveyor, through an internship during the summer of 2006 and employment after graduation

EDUCATION Purdue University, West Lafayette, Indiana
Bachelor of Science in Land Surveying and Geomatics Engineering
Expected graduation in December 2006
GPA: 3.08 of a possible 4.0 Major GPA: 3.43 / 4.0

EMPLOYMENT Richard E. Ward & Associates, Anderson, Indiana, Summers 2003 & 2005
Surveying Survey Crew Member: Conducted field work for various land surveying projects, including boundary surveys for subdivision lots and meets and bounds descriptions, ALTA / ACSM surveys, and section breakdowns
Operated total station and data collector, collaborated with crew chief to solve problems in the field, held rod / prism.
Other Lone Star Steakhouse, Anderson, Indiana, 2001-2003
Waiter / Host: Waited on customers, took orders, cleared tables, washed dishes, painted, cleaned restrooms
Blimpie Subs and Salads, Anderson, Indiana, 2002-2003
Sandwich "Artist": Sandwich maker, took orders, maintained dining area cleanliness, operated meat slicer

COMPUTER SKILLS AutoCAD, MATLAB programming, Microsoft Word & Excel, ArcGIS
Mentor Software, CORPSCON, TDS Ranger Data Collector

COURSES LS 400 – Summer Geomatics Engineering Design Project – Summer 2005
Designed and executed a survey for the Sycamore Council Girl Scouts of Tippecanoe County. Personal work included designing and establishing a GPS control network, total station calibration, topographic surveying, report synthesis, and existing point recovery

AWARDS / ACTIVITIES Semester Honors – Purdue University – Fall 2004 Term
ACSM / Indiana Society of Professional Land Surveyors Purdue Student Chapter
2002 Indiana Academic Scholar Award
2002 Distinguished Student of Madison County, Indiana

REFERENCES Available upon request

MAY
2007
GRADUATES

Jeffrey D. Fox

jdfox@purdue.edu

Current Address

3660 Goodall Court
West Lafayette, IN 47906
(574) 850-0839 (cell)

Permanent Address

2020 Dorwood Drive
South Bend, IN 46617
(574) 232-8583

OBJECTIVE

To obtain a position that utilizes the knowledge I have received in the fields of Civil and Land Surveying Engineering.

EDUCATION

Purdue University West Lafayette, Indiana

School of Civil Engineering Dual Degree Program:

Bachelor of Science in Civil Engineering, May 2007

Bachelor of Science in Land Surveying & Geomatics Engineering, May 2007

EMPLOYMENT EXPERIENCE

Survey Draftsman, The Schneider Corporation Lafayette, IN

January 2005 - Present

- Prepare ALTA/ACSM Land Title Surveys, topographic surveys, preliminary and final subdivision plats
- Create easement exhibits and point calculation sheets for construction staking
- Monitor/Update As-Built drawings for residential projects

Survey Draftsman, The Schneider Corporation Lafayette, IN

May 2004 – August 2004

- Organized and reduced field collected data; completed subdivision plat checks
- Prepared point calculations for construction staking, strip topographic surveys, and easement exhibits

Survey Instrument Operator, The Schneider Corporation Lafayette, IN

August 2003 – December 2003

- Worked with field crews as an instrument operator performing ALTA/ACSM Land Title surveys, boundary surveys, topographic surveys and construction staking projects for commercial and residential

Survey Instrument Operator, The Schneider Corporation Lafayette, IN

January 2003 – May 2003

- Worked with field crews as an instrument operator performing topographic surveys, as-builts, and construction staking projects for commercial and residential

Survey Rodman, The Schneider Corporation Indianapolis, IN

May 2002 – August 2002

- Worked with field crews as rodman performing construction staking for commercial and residential, surveys for INDOT using GPS, surveyor location reports, and topographic surveys

SKILLS & ABILITIES

Software Experience: Microsoft Excel, PowerPoint, and Word; MATLAB, MathCAD, C Programming, CCSurv, ArcGIS, ArcView GIS, Eagle Point, Trimble Geomatics Office, Autodesk Land Desktop

Equipment Experience: Trimble 5600 Total Station, Trimble 5800 GPS System, V.depth Measure Down System, V.link RTK Communication System, Wild NA2 Automatic Level

HONORS & ACTIVITIES

- ENGR 106: Engineering Problem Solving & Computer Tools Carnival Game Design - Best in Lecture
- Student in the Cooperative Education Program
- CO-OP Student Association (CSA)
- ACSM/ISPLS and ASCE Student Chapters at Purdue University
- St. Joseph Valley Chapter ISPLS Scholarship Recipient
- Initial Point Chapter ISPLS Scholarship Recipient
- Margaret Cunningham Scholarship Recipient

Nathan D. Harris

Current Address

3398 Edison Dr.
West Lafayette, IN
(765) 497-0330
nharris@purdue.edu

Permanent Address

686 Sunbird Circle
Indianapolis, IN 46231
(219) 613-7835

OBJECTIVE

To obtain an internship position that will develop my design skills and allow me to utilize my leadership characteristics.

EDUCATION

Purdue University

Junior – Civil Engineering

Semester GPA - 3.46

Overall GPA - 2.84

January 2005

WORK EXPERIENCE

Kiewit Industrial Company - Lenexa, Kansas

Intern-Estimator

Projects – Power Plants

- Concrete, rebar, and structural steel quantity take-offs
- Assembled structural steel bid package
- Analyzed bids from subcontractors and material vendors
- Interpreted design drawings
- Maintained and populated a database of the cost reports
- Studied and analyzed historical data

May 2004 – August 2004

Kiewit Industrial Company - Lenexa, Kansas

Intern-Field Engineer

Projects – Power Plants

- Performed quantity and man-hour tracking
- Updated labor distribution reports, productivity quantity charts
- Performed weekly quality and safety inspections of project site
- Delivered quality and safety reports
- Ordered small tools and miscellaneous items

May 2003 – August 2003

ACTIVITIES

National Society of Black Engineers, Purdue University

- Corresponding Secretary, 2005
- Grand Prix Co-chair, 2003 - present
- Tutor for local middle school children, 2004 - present

Academic Challenge Grant, Purdue University

- Team leader, 2004
- Team member, 2003

American Society of Civil Engineers, Purdue University

- Member 2004-present

COMPUTER SKILLS

- Packages - MS Office, AutoCAD 2004, MATLAB, MathCAD, Eagle Point
- Languages – C
- Database - MS Access

Thomas "Ryan" Henderson

Objective To apply the knowledge and skill I have received as an engineering student at Purdue University while contributing to relevant experiences in the field of land surveying.

Experience Summer '05 Intech Consultants Downers Grove, IL

Survey Field Worker and Engineering Assistant

- Collected data for boundary, topo, and final grading surveys as well as laying out pipe for water main and storm sewer for developing subdivisions.
- Assisted Engineers with projects concerning storm and sanitary sewer design.

August 2004 - Present Purdue University Housing Authority West Lafayette, IN

Resident Assistant

- Counselor for 40 students
- Organize events to facilitate resident cohesiveness
- Responsible for student safety

August 2002 – 2005 Purdue University Athletics West Lafayette, IN

Tennis Manager/Stringer

- Racket repair and restoration for Purdue's Men and Women's Tennis Teams
- Provide construction and deconstruction of dual match setup
- Participate as drill partner for players

Summers '02, '03, '04 Southeastern Tennis Camps GA, FL, AL

Tennis Camp Counselor

- Organized and implemented lessons and drills for campers
- Planned and observed off court activities for campers
- Coached individual campers during tournaments throughout the summer

Education Fall '02 -- Current Purdue University West Lafayette, IN

Seeking Bachelors Degree

- Dual Degree in Civil Engineering and Land Surveying Engineering

Relevant Courses:

- CE 203 – Introduction to Land Surveying (class included the basics of field data traverses, traverse adjustments, horizontal curves, vertical curves, basics of eagle point)
- CE 303 – Engineering Surveying (more in-depth of field data traverses, traverse adjustments, horizontal curves, intersection and resection, coordinate transformations, spirals, equal tangent vertical curves, volume computation, mass diagrams, project control and stakeout, eagle point applications of all topics above)

Interests Sports, Outdoors, Construction

References References are available upon request.

Andrew J. Kincaid

akincaid@purdue.edu

Campus Address:
237 S. Grant Street
West Lafayette, IN 47906
(219)545-2449

Permanent Address:
9035 Liable Road
Highland, IN 46322
(219)923-0642

EDUCATION:

Purdue University, West Lafayette, IN expected May 2007
Senior in School of Civil and Land Surveying Engineering GPA: 3.14/4.0

Highland High School, Highland, IN June 2002
Academic Honors Diploma GPA: 3.3/4.0

Familiar Computer Applications:

Microsoft Windows XP	Microsoft Office	Microsoft Power Point
AutoCAD	Eagle Point	MathCAD
Matlab	CCSurv	ArcGIS
ArcView		

EMPLOYMENT:

2005 *Field Surveyor*, Butler, Fairman, and Seufert Civil Engineers
-topographic surveys, bridge surveys, and storm water studies

2004 *Landscaper*, Meyer Brothers Landscaping, Inc.
-survey sites, construct retaining walls, brick patios, and landscape lawns

2003 *Service Representative*, Americall Group, Inc.
-sell products of employer to former contacts of businesses

2001-2003 *Maintenance Worker*, Griffith Golf Center
-help supervise and maintain all equipment and land on the golf course

1995-2000 *Lawn Maintenance*, Mows Lawn Service
-owner in 2000, maintain all outside lawn and landscape of clients

ACTIVITIES & HONORS:

President, Zeta Psi Fraternity	Spring 2005 - Present
Chi Epsilon Civil Engineering Honor Society	Fall 2004 – Present
American Congress on Surveying and Mapping and Indiana Society of Professional Land Surveyors	Spring 2005 – Present
Member of Purdue University Disc Golf Club	Fall 2004 – Present
Vice President, Zeta Psi Fraternity	Spring 2004 – Fall 2004
House Manager, Zeta Psi Fraternity	Fall 2003 – Spring 2004
Risk Manager, Zeta Psi Fraternity	Fall 2003 – Spring 2004
Rush Chairman, Zeta Psi Fraternity	Spring 2003 – Fall 2003
Food Chairman, Zeta Psi Fraternity	Spring 2005 – Present
Supreme Council, Zeta Psi Fraternity	Spring 2003
Involved in Zeta Psi Philanthropy Events	
Awarded Clarence H. DeLong Award for Devoted Service to Zeta Psi Fraternity	

ANDREW THOMAS MILLER

atmiller@purdue.edu

Current Address

3685 Desoto Drive
West Lafayette, IN 47906
(812) 207-6248 (cell)

Permanent Address

2517 Elliot Ave
New Albany, IN 47150

OBJECTIVE

To obtain a summer internship that will allow me to use the knowledge I have received in the field of Civil and Land Survey Engineering

EDUCATION

Bachelor of Science Degree, Expected May 2007

Purdue University, West Lafayette, Indiana

Dual Degree Program

Major 1: Civil Engineering with emphasis in Transportation

Major 2: Land Surveying Engineering

GPA: 2.73/4.0

PROFESSIONAL EXPERIENCE

Intern Land Surveyor, May 2005 – Aug 2005

Costal Planning and Engineering, Boca Raton, Florida

- Worked on hydrographic surveys using HYPACK
- Collected topographic data for beach monitoring surveys
- Used the Trimble 5700/5800 Real Time Kinematics GPS devices
- Helped in planning of surveys and training of new employees

Process Handler, May 2004 – Aug. 2004, Dec. 2004 – Jan. 2005

Saint Gobain Containers, Pevely, Missouri

- Maintained quality of both cartons and bottles
- Assisted in training of new employees on the machinery and quality checks
- Helped insure “safety first” in the workplace

ACTIVITIES

Shreve Club, member, August 2003 – May 2004

Ultimate Frisbee Club Team, member, August 2003 – Present

Big Brothers and Big Sisters, member August 2005 – Present

ACSM/ISPLS, member August 2005 – Present

Clint W. Roos

2101A Cumberland Avenue
West Lafayette, IN 47906
Phone: (812) 686-2213
e-mail: croos@purdue.edu

OBJECTIVE

Aspiring Civil Engineer and Land Surveying Engineer seeking to obtain experience in pursuit of professional licensure with a civil engineering/surveying firm.

EDUCATION

Purdue University, West Lafayette, IN

School of Civil Engineering

GPA 3.89/4.0, Major GPA 4.00/4.00

Bachelor of Science in Civil Engineering-anticipated May 2007

Bachelor of Science in Geomatics Engineering-anticipated May 2007

WORK EXPERIENCE

The Schneider Corporation, Indianapolis, IN

Survey Instrument Operator

May 2003-August 2003

- Working with field crew as an instrument operator in performing topographic surveys, INDOT surveys and construction staking projects for residential developments.

The Schneider Corporation, Lafayette, IN

Survey Instrument Operator

January 2004-May 2004

- Working with field crew as an instrument operator in performing boundary surveys, ALTA/ACSM Land Title surveys, topographic surveys and construction staking projects for commercial and residential developments.

Survey Technician

August 2004-December 2004

- Drafting of ALTA/ACSM Land Title Surveys, topographic surveys, retracement surveys and preliminary and final subdivision plats.
- Management and verification of all field data collected for the aforementioned surveys.
- Preparing stakeout calculations for commercial and residential developments for all aspects of site layout.

Engineering Technician/Survey Technician

May 2005-August 2005

- Drafting all aspects of residential engineering projects including site layout, site utility and site grading design.
- Designing drainage and treatment facilities for projects per 2005 Tippecanoe County Drainage Ordinance.
- Drafting of ALTA/ACSM Land Title Surveys, topographic surveys and preliminary and final plats

COMPUTER SKILLS

- Languages: C, C++, HTML
- Operating Systems: Windows, Unix
- Software Packages: Matlab, MathCAD, Eagle Point, AutoCAD, Ftp, COGO, MS Office, Autodesk Land Desktop, Trimble Geomatics Office

ACTIVITIES AND AWARDS

Semester Honors/Deans List: Every Semester

CE Ambassador (guide and help mentor students in the CE Program)

Fall 2005-Present

Chi Epsilon – Civil Engineering Honorary Society

Tau Beta Pi – All Engineering Honorary Society

Vice President

Fall 2005

Vice President Elect

Spring 2005

Indiana Society of Professional Land Surveyors

Fall 2003-Present

Served as secretary and webmaster for student club

Fall 2005-Present

Served as a Student Representative for student club

Fall 2004-Spring 2005

American Congress on Surveying and Mapping

Fall 2003-Present

American Society of Civil Engineers

2004 – 2005 Jud and Betty Rouch Land Surveying Scholarship

2005 - 2006 ISPLS Central Indiana Scholarship Recipient

2006 - 2007 ISPLS John G. McEntyre Scholarship Recipient

Ashley L. Rose

Current Address

2501 Soldiers Home Rd Apt 13H
West Lafayette, IN 47906
765-623-0753

Email: arose@purdue.edu

Permanent Address

3119 Fall Drive
Anderson, IN 46012
765-649-0150

Objective:

I am seeking an internship with a company working in the field of civil engineering and/or land surveying.

Education:

Enrolled at Purdue University, West Lafayette, Indiana 47906
Working toward Bachelor of Civil Engineering and Bachelor of Land Surveying and Geomatics Engineering
Expected Graduation: Spring 2007
GPA: 3.49 / 4.00

Related Skills:

Software: Microsoft Office, Eagle Point (COGO), Autocad, Mathcad, C Programming, Matlab

Equipment: Trimble GPS 5800, Leica GPS, Trimble Robotic, Sokkia & Topcon EDM's, TDS Recon & Husky Ranger Data Collectors

Employment Experience:

Summer of 2005

Wiser Company, LLC

1431 Kensington Sq. Ct. Murfreesboro, TN 37130

- Survey Field Crew Member/Leader
- Projects worked on included all aspects of boundary surveys (initial survey, property line staking, and setting corners) and topographic surveys

Summer of 2004

Rayl Surveying & Engineering, Inc.

1940 East 53rd St. Anderson, IN 46013

- Survey Field Crew Member
- Projects worked on included subdivision layout, some boundary surveys, topographic surveys, construction staking etc

1997- present

Lawler-Rose Cattle Co. Anderson, IN

- Worked on family farm
- Broke and conditioned cattle
- Feed, water, and rinse cattle daily

Robert Frederick Will

rwill@purdue.edu

Campus Address

220 Sylvia Street
West Lafayette, IN 47906
+1 847 347-9118

Permanent Address

1093 St. Clair Ln
Vernon Hills, IL 60061
+1 847 347-9118

Objective

To obtain an internship position to gain experience in the Civil Engineering/Land Surveying Engineering fields.

Education

Purdue University, West Lafayette, Indiana
Civil Engineering/Land Surveying Engineering, Bachelor of Science
August 2002 to Present
Stevenson High School, Lincolnshire, Illinois
August 1999 to June 2002

Employment

Engineering Intern, May 2004 to Present
Gewalt Hamilton Associates, Inc., Vernon Hills, Illinois
Summer 2004: Performed a variety of duties under an engineering technician including: jobsite inspection and observation, construction staking, leveling, as-builts, and quantity take-offs.
Summer 2005: Worked as part of a survey crew doing topography.

Assistant Electrician, May 2003 to May 2004
Lakeshore Electrical, Inc., Highland Park, Illinois
Performed electrical work; job site maintenance. Exposure to construction practices.

Assistant Electrician, June 2001 to August 2001
Lovering Electric, Highwood, Illinois
Performed basic electrical work, assistant to licensed electrician; job site maintenance.
Exposure to construction practices.

Skills

Experience with AutoCAD, Eagle Point, Excel, Matlab, Microstation and Word.

Activities

ACSM, August 2004 to Present
Current member of ACSM and the Indiana Society of Professional Land Surveyors.

Jazz Band,

Played in the Purdue Jazz Band August 2003 to December 2004. Played bass guitar in various bands for past 8 years; Taught bass guitar lessons for 4 years.

Matthew Thomas
1520 Summit Drive
West Lafayette, IN 47906
(765) 744-2629
Thomasme@purdue.edu

JOB OBJECTIVE

To obtain an internship that will provide experience in land surveying.

EDUCATION

Purdue University, West Lafayette, IN
Geomatics Engineering, Bachelor of Science, anticipated May 2007
Civil Engineering, Bachelor of Science, anticipated May 2007

EXPERIENCE

Woolpert, Inc., Indianapolis, IN 5/2005-8/2005
Summer Intern in the Survey Department
Gained experience in topographic surveys, property surveys, control, gps, measured downs, and various other aspects of surveying. Also performed office work including minor CAD work, research, and Microsoft Access database work.

Thomas Business Center, Muncie, IN 2000-2003
Delivery/Warehouse/Systems Management
Performed basic delivery and warehouse duties
Created a literature filing system, inventory system, and barcode system

Crossroads of America Boy Scout Camp Ransburg, Bloomington, IN 6/01
Camp Counselor
Worked with youth from ages 10-18 in an outdoor setting.
Planned, coordinated, and completed several large-scale service projects demonstrating leadership ability.

Purdue Reamer Club 5/04-12/04
Boilermaker Special Chair
Planned and coordinated all activities of the Boilermaker Special, Purdue's mascot, including maintenance, training, and scheduling with the public, university, athletic department, and club.

ACTIVITIES AND HONORS

Eagle Scout, 1999
Vigil Honor, 2001, honor for outstanding leadership and service to Order of the Arrow (scouting honor society)
Minisino, 2001, honor for outstanding leadership and service to Firecrafter (scouting honor society)
Master Mason, 2003
Purdue Reamer Club, 2002, Boilermaker Special Pilot, 2003

Go-kart Racing, March 2000 to Present

Member of Badger Kart Club; driver for Harrison Hall Racing for Purdue Grand Prix.

Purdue Roller Hockey Club, January 2002 to January 2003

Played with the Purdue Roller Hockey Club for the 2002/2003 season.

Scott E. Wilkinson

Permanent Address:

924 Marleton Road
Logansport, IN 46947
574-753-8704

Campus Address:

130 S. Salisbury Apt. 2
West Lafayette, IN 47906
765-426-5625
sewilkin@purdue.edu

Objective:

- To obtain an internship in the Civil Engineering or Land Surveying Engineering field where I can develop my leadership and problem solving skills while making contributions to a corporation.

Education:

Purdue University School of Civil Engineering

Bachelor of Science in Civil Engineering, May 2007

Bachelor of Science in Land Surveying and Geomatics Engineering, May 2007

Current GPA: 2.55/4.0

- **Related Courses Completed by Fall 2005:** Calculus (three semesters), Linear Algebra, Physics (two semesters), Statics, Dynamics, Introduction to Structural Mechanics, Materials I & II, Computer Graphics Technology, Engineering Surveying, Geomatics, Land Survey Systems, Analysis of Survey Observations, Data Adjustment, Legal Aspects of Surveying, GIS, Probability and Statistics.
- **Computer Skills:** C programming, Matlab, MOVE3, UNIX, MS Excel, MS PowerPoint, AutoCAD, Mathcad, Eagle Point, and other COGO packages.

Work Experience:

- **Wilkinson Heating and Air Conditioning** **Logansport, IN** **Summers 2002-04**
Worked as HVAC apprentice while gaining knowledge and leadership skills on the job site. Worked mainly in a team environment on both commercial and residential buildings on an installation crew. Learned how to apply engineering skills in the design of HVAC systems.
- **Manhard Consulting Ltd.** **Lombard, IL** **Summer 2005**
Worked on a survey crew doing various types of surveying including: construction staking, as-builts and updates, boundary work and topographic work. Was able to get experience using an RTK GPS equipment, along with VRS equipment. Worked in a team setting on both commercial and residential job sites.

Campus Activities:

- Indiana Greek Leadership Conference
- Carlson Leadership Academy
- American Society of Civil Engineers
- American Congress on Surveying & Mapping (Purdue Chapter)
- Indiana Society of Professional Land Surveyors (Purdue Chapter)
- United Way Fundraiser
- Sigma Phi Epsilon Fraternity, Indiana Alpha
- Intramural Athletics

