

**PURDUE UNIVERSITY**  
**LAND SURVEYING &**  
**GEOMATICS ENGINEERING**

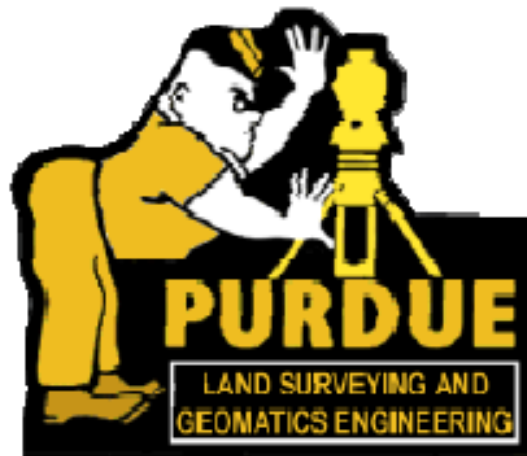

**RESUME BOOK**

**2007 – 2008**

**School of Civil Engineering**

**Land Surveying and Geomatics Engineering**

**Student Chapter of the American Congress on**

**Surveying and Mapping**

**&**

**Indiana Society of Professional Land Surveyors**

# ACSM and ISPLS Purdue Student Chapter

## Resume Book

Fall 2008



<u>Student</u>	<u>Expected Graduation Date</u>
Matthew Fillmore.....	May 2009
Peter Fovargue.....	May 2010
Eric Fujikawa.....	May 2008
Jason Gaspar.....	May 2009
Michael Goralski.....	August 2008
Jacob Hoffman.....	May 2009
Gerald South.....	May 2008
Adam Tyra.....	December 2008
Joshua Werner.....	December 2008
Seth White.....	December 2008

# Matthew Walker Fillmore

106 Connolly St.

West Lafayette, IN 47906

Phone: (765) 418-2432 Email: mfillmor@purdue.edu

## **Objectives:**

To acquire an internship that is stimulating and challenging in the fields of civil engineering and land surveying. I am interested in a mix of field work and computational design.

## **Education:**

College of Civil Engineering

Status: Senior

Degrees in progress:

General Civil (BSCE)

GPA: 2.96/4.0

## **Proficient in:**

Auto Cad Arc Gis

Matlab Unix

C-programming Math Cad

Eagle Point

## **Experience:**

**Tippecanoe County Surveyors Office** May of 2007 to present

survey technician	section-corner maintenance
benchmark propagation	georeferencing old aerial
drainage checks	level loops

**Parsons Cunningham and Shartle Engineers** . Avon, Indiana

(Summer of 2006)

survey technician

cad mark ups

check calculations

Types of surveys:	topography	construction staking
	Alta	level loops

**The Lily Barn** - Townsend, Tennessee (Summers of 2000-2005)

residential construction maintenance

equipment operator

## **Community Activities:**

Eagle Scout

Habitat for Humanity

President of the Purdue Water Ski Club 2005-06

Team and club member 2004-07

Participated in Mission Trips (2002, 2003, 2004, 2005)

Construction Crew Leader for (2004, & 2005)

# **Peter David Fovargue**

**(740)504-9701**

**pfovargu@purdue.edu**

## **Campus Address:**

**#343 Hillenbrand Hall  
1301 Third Street  
West Lafayette, IN 47906**

## **Permanent Address:**

**20297 Arrington Rd  
Utica, Ohio 43080**

## **EDUCATION:**

- **Current Sophomore Civil Engineering Student at Purdue University**
- **Graduate with a Bachelors in Civil Engineering (Expected Spring 2010) and a Masters in Geomatics Engineering (Expected Spring 2011)**

## **ACTIVITIES:**

- **Member of Purdue Rowing Team**
- **President and Treasurer of the Utica FFA Chapter, American FFA Degree**
- **Eagle Scout of Boy Scout Troop 28**
- **High School Varsity football team, Team Captain**
- **High School Varsity Track, Team Captain, Coaches Award 3 years**
- **Extemporaneous Speaking Contest for FFA Chapter, County winner**

## **WORK EXPERIENCE:**

- **2007 Summer Internship with Kokosing Construction Company of Fredricktown, Ohio. Worked on Survey Field Crew as *Rodman* in the field doing construction layout, topographic work, and profile leveling.**
- **2005 – 2007 Horse farm employee**
- **2002 – Present Own and manage a small sheep production business.**

## **Related Skills:**

- ***Software:* Microsoft Office, Eagle Point (COGO), Autocad 2007, Matlab, Mathcad**
- ***Equipment:* Experienced with Total Stations, Levels, GPS Rover, Data Collector**

## **COMMUNITY SERVICE:**

- **Many projects through Boy Scouts including a 204 hour service project**
- **Several activities through Purdue Rowing team**

**References upon request.**

# Eric I. Fujikawa

efujikaw@purdue.edu

Campus Address:  
151 South Grant Street  
West Lafayette, IN 47906  
(253) 961-9532

Permanent Address:  
4126 Hili Street  
Lihue, HI 96766  
(808) 245-6629

## OBJECTIVE

- To earn a position in the field of civil engineering and/or land surveying and geomatics engineering.

## EDUCATION:

- Purdue University, West Lafayette, Indiana GPA: 3.3/4.0
  - Bachelor of Science in Civil Engineering (BSCE) expected May 2008
  - Bachelor of Science in Land Surveying and Geomatics Engineering (BSLSGE)
- Relevant Courses:
  - Route Surveying, Property Surveys and Descriptions, Land Survey Systems, Geographic Information Systems, Photogrammetry, Conformal Mapping, Data Adjustment, Urban Hydraulics, Legal Aspects, Urban Planning
- Computer Applications:
  - AutoCAD, Eagle Point, Autodesk Land Desktop, Autodesk Civil3D, ArcGIS, ArcView, Move3, Matlab, MathCAD, Mentor Software, Corpcon

## EMPLOYMENT:

2004-2007 *Esaki Surveying & Mapping Inc. (Puhi, HI)*  
*Survey/Engineering Technician*

- Field Crew Member
  - Worked as a rodman and instrument operator in performing topographic surveys, boundary surveys, ALTA/ACSM Land Title Surveys, route surveys, precise leveling, as-built surveys, construction staking projects for residential and commercial developments, shoreline certifications, and quantity takeoff surveys.
- Draftsman
  - Create plots for topographic surveys, boundary surveys, ALTA/ACSM Land Title Surveys, shoreline certifications, preliminary and final subdivisions, construction drawings, as-built surveys, route surveys, and quantity takeoff surveys.
  - Prepare boundary/construction stakeout files, legal land descriptions, subdivision design work, quantity takeoff sheets.

## ACTIVITIES AND AWARDS

- Lambda Sigma – Land Surveying Honorary Society Fall 2007-Present
  - Vice President (2007-Present)
- ACSM/ISPLS Purdue Student Chapter Fall 2006-Present
- Hui Na Opio O Hawaii – Purdue Hawaii Club Fall 2003-Present
  - Vice President (2006-2007)
  - Treasurer (2007-Present)
- Purdue Roller Hockey Club Fall 2003-Present
  - Vice President (2007-Present)
- American Water Works Association Scholarship 2003-2004
- Robert C. Byrd Scholarship 2003-2007
- Jud and Betty Rouch Land Surveying Scholarship 2005-2006
- Topcon Positioning Solutions Scholarship 2006-2007
- Wallace R. Vawter Scholarship 2006-2007

# Jason Michael Gaspar

---

Primary Address:  
1307 Shining Armor Lane  
West Lafayette, Indiana 47907

Permanent Address:  
16449 Morton Place  
Lowell, Indiana 46356

Phone: 765-463-5392  
Cell Phone: 219-306-1425  
Home Phone: 219-696-1432  
E-mail: jgaspar@purdue.edu

## Objective

To obtain an internship for the summer 2008 with a civil engineering company dealing with surveying and site development.

## Education

**B.S Civil Engineering**, expected May 2009  
**B.S Land Surveying and Geomatics Engineering**, expected May 2009  
**Purdue University, West Lafayette Indiana**

Significant Courses: Geomatics, Engineering Surveying, Survey Observations, Land Survey Systems, Geographic Information Systems, Hydraulics, Transportation, Geotechnical Engineering, Materials, Pavement Design, Construction Management, Construction Estimates

## Experience

**Mecon Industries Inc.**, Lansing, Illinois  
Summer Apprentice, Summers 2004-2007  
Prefabrication of Piping for Field Crews  
Job Site Preparation and Layout  
Safety Responsibilities: Ground-Man, Hole-Watch, Fire-Watch  
Assisting in Quality Control  
Delivering Bids  
Delivering Site Materials  
Office/Warehouse Maintenance

## Computer Skills

AutoCAD, EaglePoint, MatLab, MathCAD, ArcGIS

## Clubs

Purdue ACSM  
Purdue ISPLS  
Hoosier Herpetological Society

## Activities

Reptile Education  
Snake Keeper and Breeder

# Michael Patrick Goralski

**Campus Address:**  
209 Harrison Street #3  
West Lafayette, IN 47906  
Cell phone: 317-418-0432  
mgoralsk@purdue.edu

**Permanent Address:**  
1111 West 73<sup>rd</sup> Street  
Indianapolis, IN 46260  
Home phone: 317-253-7397

## Objective

To obtain a full time position where I can utilize my skills in Civil Engineering and Land Surveying, with a focus in Construction Management.

## Education

**Purdue University**  
August 2003-current

**West Lafayette, IN**

**August 2008**

- Working towards a Bachelor of Science in Civil Engineering and a Bachelor of Science in Land Surveying and Geomatics Engineering
- Course training in AutoCAD, Eagle Point, MathCAD, MatLab, and Microsoft Office products
- Course work in Materials I & II (concrete and asphalt), Surveying, Transportation, GIS, Structures, Hydraulics, Estimating, Physics, Math, Geotechnical Engineering, Management, Photogrammetry, Scheduling, Planning, Boundary Principles, and Composition

## Experience

### Field Engineer Intern

June 2007-August 2007

Flatiron Construction Corporation

New Roads, LA

- Assisted field and project engineers in various tasks including: quantity takeoffs, concrete testing, girder deliveries, pile driving, bridge deck paving, and overhang design.

### Surveying Intern

May 2006-August 2006

Woolpert Inc.

Indianapolis, IN

- Learned to become more efficient with a total station and static and RTK GPS, while traveling and working in various parts of south-east United States.

### Engineering Intern

June 2005-August 2005

Manhard Consulting Inc.

Vernon Hills, IL

- Became familiar with total stations, stake out procedures, and learned valuable field skills
- Spent time in the office where I learned basics of lot grading, utility layout, and formal permit procedures

### Independent Sales Representative

May 2004-August 2004

Vector Marketing Corporation

Indianapolis, IN

- Learned the art of direct sales, self-motivation, time management skills, and great sales tips, all while selling high quality kitchen cutlery

## Activities

- Sophomore Leadership Development Conference
- National Forensics League
- Academic Super Bowl – Fine Arts Division
- Student Chapter Purdue ACI
- Secretary of ACSM and ISLPS

# Jacob T. Hoffman

Home: 410 East Washington Street  
Martinsville, IN 46151  
Phone: (765) 326-2172  
E-Mail: jthoffma@purdue.edu  
Birthdate: March 23, 1985

## Objective:

My objective is to obtain a full time job that will best use and expand my knowledge and skills in the surveying industry.

## Academic History:

Pursuing a Bachelor of Science Degree in Land Surveying at Purdue University.  
Attended IUPUI studying Computer Science 2003-2006  
Attending Purdue University studying Geomatics 2006-Current  
Anticipated Graduation Date: May 2009  
GPA: 2.89 / 4.0

## Volunteer Work:

- Served as Deacon at First Baptist Church Martinsville 2005-2006
- ASCM Purdue Chapter 2006-Current
- ASCM Webmaster 2007
- IAESTE Purdue Chapter 2006-Current
- IAESTE Reception Coordinator 2007
- Purdue Christian Campus House Sound Force 2006-Current
- Purdue University Trap and Skeet Club 2007-Current

## Work Experience:

**Moses Surveying** May 2006-Current  
*Survey Technician*

- Field and office work for boundary surveys, topo surveys, ALTA surveys, surveyor location reports, plot plans, subdivision design, level circuits.
- Contact: Ron Wharry, Owner, (765) 654-5910

**Drapalik Surveying and Engineering** October 2004-May 2006  
*Survey Technician*

- Field work for boundary surveys, topo surveys, ALTA surveys, surveyor location reports, plot plans, level circuits, static GPS surveying.
- Contact: John Drapalik, Owner, (765) 342-3806

**Mag Inc** June 2001-October 2004  
*Staff Support Injection Plastic Molding*

- Managed warehouse, quality control, janitorial services
- Contact: Rod Fye, President, (765) 349-9487



# Gerald W. South

---

3309 Backmeyer Road  
Richmond, IN 47374  
Cell: (765) 404-8394  
geraldsouth@gmail.com

## OBJECTIVE

To obtain a permanent position within a civil engineering firm that will allow me the opportunity to pursue professional registration in the fields of land surveying and civil engineering. Areas of interest include land development and design.

## EDUCATION

Purdue University, West Lafayette, IN  
B.S. in Civil Engineering, anticipated May 2008  
Emphasis in Construction  
B.S. in Land Surveying and Geomatics Engineering, anticipated May 2008

## COMPUTER SKILLS

Proficient using: AutoCAD, Carlson SurvCAD XML2, Bentley FlowMaster, Microsoft Word, Microsoft Excel, Microsoft PowerPoint.

## EXPERIENCE

**Beals Surveying Corporation**  
**122 South Eighth Street**  
**Richmond, Indiana 47374**  
***Design Coordinator 2004 - 2008***

Executed site design for commercial development and design of residential subdivisions, focusing on horizontal and vertical design for parking lots, drives, streets, utilities, including storm sewers and waterlines. Prepared construction cost estimates, drainage reports for approval by local agencies, and construction plans. Represented the firm with clients, consultants, contractors, and government officials including the Indiana Department of Transportation (INDOT), and Indiana Department of Environmental Management (IDEM).

**Whitewater Construction Inc.**  
**1417 Sheridan Street**  
**Richmond, Indiana 47374**  
***Assistant Project Manager 2006 - 2008***

Compiled construction closeout documentation, prepared construction layout. Drafted, created shop drawings, and performed field measurements for a variety of projects, including light industrial complexes, restaurants, medical offices and other businesses.

**Maze Design Group Inc.**  
**3300 Geraldine Lane**  
**Richmond, Indiana 47374**  
***Lead Draftsman 1997 - 2008***

Developed and prepared schematic drawings, construction documents, and shop drawings, and modified existing drawings for commercial, industrial, institutional, and residential applications.

## AFFILIATIONS

Treasurer of Purdue student chapter of American Congress of Surveying And Mapping  
Member of Purdue student chapter of American Society of Civil Engineers.

# ADAM TYRA

## Permanent:

8218 Stoney Bend Circle  
Indianapolis, IN 46259

ATyra@purdue.edu

home:(317)862-2956  
cell: (317)694-0791

## Campus:

107 MacArthur Drive  
West Lafayette, IN 47906

## Objective:

- ▲ Receive an internship for the summer of 2008 working on projects involving transportation engineering and/or land surveying engineering.

## Education:

- ▲ Purdue University, West Lafayette, IN Expected Graduation Date: December 2008
- ▲ School of Civil Engineering, dual degree in Transportation and Land Surveying Engineering
- ▲ G.P.A.: 3.23

## Work Experience:

- ▲ Benjamin Harrison Residence Hall - Resident Assistant Fall 2006-Present
  - Responsible for building and maintaining a community of 52 students on my floor
  - Responsible for setting up and executing programs meant to stimulate the residents of Harrison Hall socially, mentally and/or developmentally
  - On duty typically four nights every week, during which rounds are performed
- ▲ Joint Transportation Research Program - Research Assistant Summer 2006, 2007
  - Assisted in a study on vehicle detection devices, including side fire radar and microloops
  - Aided in a study on pedestrian-vehicle conflicts in downtown Indianapolis
  - Assisted in a study on split analysis at an intersection in Noblesville, IN using video obtained by Autoscope to study changes in detector reliability as well as frequency of split failures and high flow rates.
  - Gathered data to perform a preliminary analysis regarding roundabout safety in Indiana
- ▲ Edwards and Kelcey - Summer Engineering Intern Summer 2005
  - Applied knowledge of Microsoft Word, Excel, Powerpoint, Autocad to complete responsibilities
  - Worked on inventorying bus stops for IndyGo in Indianapolis
  - ❖ Collected measurements in the field of 30+ characteristics at each stop while working under the guidance of a Professional Engineer.
  - Performed turning movement counts in Indianapolis and nearby areas
  - Compiled data and used Highway Capacity Software to determine the level of service of various roads and optimum signal timing for intersections
  - Worked on rough cost estimates based on plans and other resources
  - Made site visits to various intersections throughout Indiana for data gathering purposes

## Extracurricular Activities at School:

- ▲ Lambda Sigma: Land Surveying Honor Fraternity - President Spring 2007-Present
  - Invited to join  $\Lambda\Sigma$  based on high academic achievements
- ▲ Chi Epsilon: Civil Engineering Honor Fraternity Spring 2007-Present
  - Invited to join XE based on high academic achievements
- ▲ ACSM/ISPLS Student Chapter at Purdue Fall 2006-Present
- ▲ Alpha Phi Omega National Co-Ed Service Fraternity -  $\text{A}\Gamma$  Chapter Fall 2004-Present
  - Completed the LEADS program
    - ❖ Teaches the servant leader model upon which leadership in  $\text{A}\Phi\Omega$  is based
    - ❖ Consists of five parts which last two hours up to an entire weekend depending on the course
  - Positions Held:
    - ❖ Scouting Service Co-chair Fall 2006
    - ❖ Pledge Trainer Buddy twice Spring 2005 and Fall 2005
    - ❖ Chapter Overnighter Co-chair twice Fall 2005 and Spring 2006
    - ❖ Fundraiser Co-chair Spring 2005
    - ❖ Vice President of Finance for pledge class Fall 2004

## Computer-Related Skills:

- ▲ Autocad, Microsoft Office, Matlab, Mathcad, Eaglepoint, Corpcon, Move3

## Personal Strengths:

- ▲ leadership, team work, time management, honest, punctual, responsible, open-minded, analytical

# Joshua Werner

## Contact Information

### Campus Address

412 Dodge St. Apt. 10  
West Lafayette, IN 47906  
(812) 212-9603  
jdwerner@purdue.edu

### Home Address

1113 Columbus Ave.  
Batesville, IN 47006  
(812) 934-5297

## Objective

I would like to obtain an internship or career in Land Surveying with your company.

## Education

-I am currently a senior in the School of Civil Engineering at Purdue University. I intend to graduate with a degree in Land Surveying and Geomatics Engineering in December of 2008.

-I was also awarded the Academic Honors Diploma from high school.

*Relevant Coursework* – Introduction to Geomatics, Engineering Surveying, Land Survey Systems, Analysis of Survey Observations, Calculus, Linear Algebra, Computer Graphics Technology, Hydraulics, Photogrammetry and Remote Sensing

## Work Experience

### Koehne Construction

Batesville, IN

Summers of 2002 – 2005

*Construction Worker* – I actively helped in the construction of several structures including pole barns, decks, and houses.

### Woolpert, Inc.

Indianapolis, IN

Summer of 2006

*Survey Technician* – I helped perform several construction stakeouts, topographic surveys, and boundary surveys.

### Seig and Associates, Inc.

Sunman, IN

Summer of 2007

*Survey Technician* – I performed several boundary surveys, construction staking, and drafting.

### Purdue Food Stores

West Lafayette, IN

Aug. 29, 2005 – May 5, 2006

Aug. 21, 2006 – May 4, 2007

Aug. 20, 2007 - Present

*Warehouse Laborer* – I help prepare and distribute food orders to the several dining courts at Purdue.

## Clubs / Organizations

- Student member of the ISPLS
- Current president of the Purdue Chapter of ACSM / ISPLS
- Member of Purdue Trap and Skeet Club

## Other Skills

I am very familiar with computers and the following computer tools among others:

- Microsoft Office
- MATLAB
- C-Programming
- COGO
- AutoCAD
- MathCAD
- EaglePoint

# Seth White

white41@purdue.edu

Home Address:  
6154 South State Road 17  
Kewanna, IN 46939  
(574) 653-2856

Campus Address:  
147 East Oak Street  
West Lafayette, IN 47906  
(574) 817-0511

**Objective:** A Civil Engineering/Land Surveying Engineering position that will enhance and utilize my skills and knowledge.

## **Education:**

**Bachelor of Science (BS)**, in Progress, Purdue University, West Lafayette, IN December 2008  
Currently a Senior in **Land Surveying Engineering**

**Significant Courses:** Computer Graphics Technology    GPS    GIS  
Data Adjustment    Economics    Elementary Surveying

## **Skills:**

- Accurately type 70 words per minute
- Proficient in Microsoft Word, Excel, Matlab, Unix, Autocad, Access and Powerpoint, Mathcad
- Manage own 550 acre farm

## **Work Experience:**

**Surveying,** The Schneider Corporation, West Lafayette, Indiana Summer 2007

- GPS
- Conventional
- Topography, Boundary, and Control
- ALTA/ACSM

**Farm Owner/Operator,** White Farms, Kewanna, Indiana (From Birth to Present)

- Work on home family own farm of 1800 acres as well as manage my own land (550 acres).
- Plant, Harvest, and Spray all acres.
- Manage all paper work related to agriculture

**Construction:** Bonnell Grain Handling, Star City, Indiana Summer 2005

- Built Grain Bins and Grain Legs
- Worked with Steel and Concrete
- Put up a bin 2006 for Alexander Farms

## **Activities:**

- Vice President of ISPLS Purdue Chapter
- Member of the Tecumseh Chapter